

Land late by  
D. Witherup

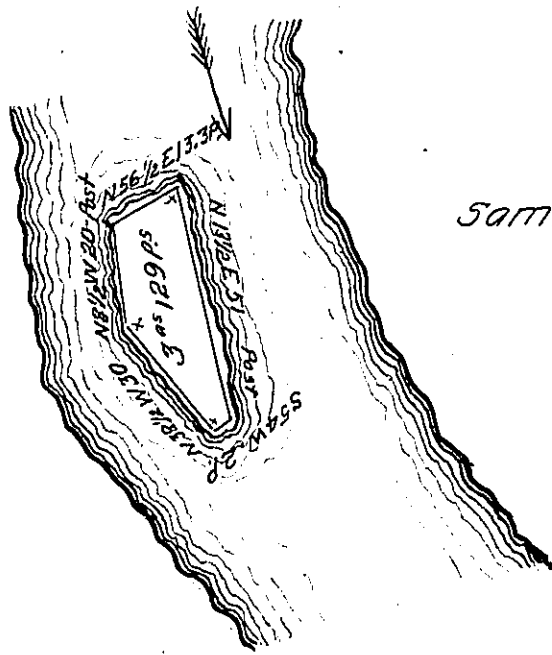

Sam! Steffer

Draft of an Island Situate in the Allegheny River in Sandy Creek Township,  
 Venango County, opposite to land late by D. Witherup on the West and land of  
 Sam! Steffer on the East Side of the River the Second Island below Big Sandy  
 Creek. Surveyed February 13<sup>th</sup> 1865 for M. L. Whan Esqr. in pursuance of a  
 Warrant granted to him dated the 6<sup>th</sup> day of February A.D. 1865.

Hon. J. P. Barr

W<sup>m</sup> Hilands

Surveyor Genl

C.S.

IN TESTIMONY that the above is a copy of the original remaining on file in  
 the Department of Internal Affairs of Pennsylvania, made  
 conformably to an Act of Assembly approved the 16th day of  
 February 1833, I have hereunto set my hand and caused  
 the Seal of said Department to be affixed at Harrisburg,  
 this Seventh day of June 1907

*Henry Howell*  
 Secretary of Internal Affairs.